

## TOMZN MODULAR CONTACTOR

TOCT1 contactors are available in two versions:

- Contactors without manually-operated
- Contactors with manually-operated.

The breadth of the iCT contactor range satisfies most application cases.

TOCT1 contactors can be combined with auxiliary control, protection and indication functions

1. Electric ratings Current: up to 20A, 25A, 32A, 40A, 63A,  
Voltage: 220V, AC50/60Hz;  
Utilization category: AC-1, AC-7a, AC-7b;  
Standard: IEC / EN 61095

### 2. Features

Compact design and modularization design;

Insulation material with excellent performances has been adopted to enhance the operation security to a great extent;

Elegant appearance. A mounting instruction diagram is appended for convenient operation;

No noise during operation.

Type	Contactor							
Rating	A	16	20	25	32	40	63	100
Auxiliaries		Yes						
BACTs indication auxiliary		Yes						
BACT control auxiliary	By yellow clips	Yes						

Type	Rating(In) AC-7a	Rating(In) AC-7b	Control voltage (VAC)(50Hz)	Contact	Width in 9 mm modules
1P					
	16A	6A	24	1NO	2
	20A	7A	110	1NC	
	25A	9A	230		
2P					
	16A	6A	24	2NO	2
	20A	7A	110	1NO+1NC	
	25A	9A	230	2NC	
	32A	12A	24	2NO	4
	40A	18A	110	1NO+1NC	
	63A	25A	230	2NC	
	100A	-	24	2NO	
	100A	-	110	2NO	6
			230		
3P					
	16A	6A	24	3NO	4
	20A	7A	110	3NC	
	25A	9A	230		
	32A	12A	24	3NO	6
	40A	18A	110		
	63A	25A	230	3NC	
	100A	-	24		
	100A	-	110	4NO	12
			230		
4P					
	16A	6A	24	4NO	4
	20A	7A	110	4NC	
	25A	9A	230	2NO+2NC	
	32A	12A	24	4NO	6
	40A	18A	110	4NC	
	63A	25A	230	2NO+2NC	
	100A	-	24	3NO+1NC	
	100A	-	110	4NO	12
			230		

Your Reliable Partner

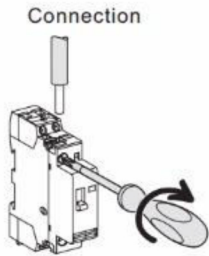

Type	Rating	Length tripping	Circuit	Tightening torque	Copper cables	
					Rigid	Flexible or ferrul
PZ1:4 mm	16-100A	9mm	Control	0.8N.m	1.5to 2.5mm <sup>2</sup> : 2 × 1.5mm <sup>2</sup>	1.5to 2.5mm <sup>2</sup> : 2 × 2.5mm <sup>2</sup>
	16 and 25A				1.5to 6mm <sup>2</sup>	1 to 4mm <sup>2</sup>
PZ2:6 mm	40A-63A	14mm	Power	3.5N.m	6 to 25 mm <sup>2</sup>	6 to 16 mm <sup>2</sup>
	100A				6 to 35mm <sup>2</sup>	6 to 35mm <sup>2</sup>
PZ1:4mm	-	9mm	-	0.8N.m	1.5to 2.5mm <sup>2</sup> : 2 × 1.5mm <sup>2</sup>	1.5to 2.5mm <sup>2</sup> : 2 × 2.5mm <sup>2</sup>

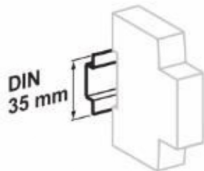

Clip on DIN rail 35 mm.



± 30° vertical.

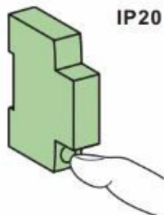

IP20

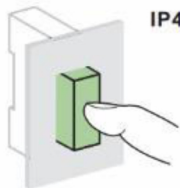

IP40

## Technical data

### Power circuit

Voltage rating(Ue)	1P,2P	250V AC
	3P,4P	400V AC
Frequency	50Hz or 60Hz	

### Endurance(O-C)

Electrical	100,000 cycles
Maximum number of switching operation a day	100

### Additional characteristics

Insulation vwlage(Ui)	500 V AC	
Pollution degree	2	
Rated impulse withstand voltage(Uimp)	2.5kV(4 kV for 12/24/48V AC)	
Degree of protection (IEC 60529)	Device only	IP20
	Device in modular enclosure	IP40
Operating temperature	-5°Cto+60°C <sup>II</sup>	
Storage temperature	-40°Cto+70°C	
Tropicalization(IEC 60068-1)	Treatment 2(relative humidity 95% at 55°C	
ELSV compliance(Extra Low Safety Voltage)for 12/24/48vac versions		
The product control conforms to the SELV(safety extra low voltage)requirements		

(1)In the case of contactor mounting in a enclosure for which the interior temperature is in range between 50°Cand 60°C,it is necessary to use a spacer, between each contactor

